

BISOFIX® E32

(D 03 38)

for insulated pipes 12.0 - 273.1 mm

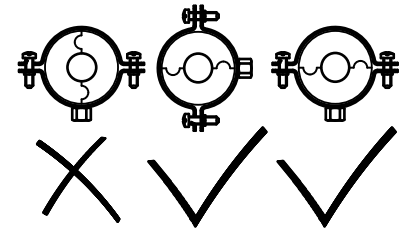

Features and Benefits

- for combination with elastomeric foam insulation
- temperature range -45 °C - +105 °C
- vapourproof glueable with pipe insulation
- does not contain CFC, HCFC, formaldehyde or cadmium
- fire class B2
- PIR density for D <80mm = 80kg/m³
- PIR density for D >80mm = 120kg/m³

Part No.	D (mm)	D (")	DN	L	H (mm)	s (mm)	F _{az} (N)	Pack 1
I320000012	12.0	-	-	50 mm	76.6	32.3	100	25
I320000015	15.0	-	-	50 mm	80.0	32.5	100	25
I320000018	17.2 - 18.0	3/8	10	50 mm	82.6	32.3	100	25
I320000022	21.3 - 22.0	1/2	15	50 mm	88.0	33.0	100	25
I320000028	27.0 - 28.0	3/4	20	50 mm	100.0	36.0	100	25
I320000035	33.7 - 35.0	1	25	50 mm	100.0	32.5	100	25
I320000042	42.4	1 1/4	32	50 mm	108.0	32.8	150	25
I320000048	48.3	1 1/2	40	50 mm	112.9	32.3	225	25
I320000054	54.0	-	-	50 mm	124.6	35.3	225	25
I320000060	60.3	2	50	50 mm	124.9	32.3	350	25
I320000064	64.0	-	-	50 mm	152.0	44.0	350	15
I320000070	70.0	-	-	50 mm	152.0	41.0	425	15
I320000076	76.1	2 1/2	65	50 mm	156.7	40.3	575	15
I320000089	88.9	3	80	50 mm	176.1	43.6	875	5
I320000102	101.6	-	-	50 mm	192.0	45.2	1,000	5
I320000108	108.0	-	-	50 mm	192.0	42.0	1,075	5
I320000114	114.3	4	100	50 mm	194.9	40.3	1,250	5
I320000133	133.0	-	-	100 mm	218.4	42.7	1,475	5
I320000140	139.7	5	125	100 mm	220.3	40.3	1,700	5
I320000160	159.0 - 160.0	-	-	100 mm	241.0	40.5	1,950	3
I320000168	168.3	6	150	100 mm	248.9	40.3	2,125	3
I320000219	219.1	8	200	100 mm	315.1	48.0	3,525	3
I320000273	273.1	10	250	100 mm	353.6	40.3	4,925	3

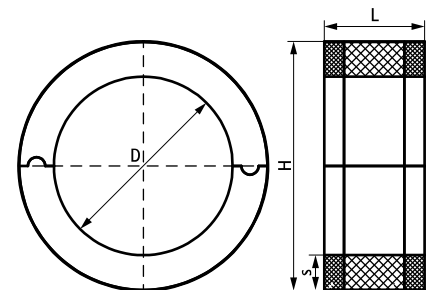

Complementary

Bifix® G2 (M8/10) (BUP1000)
 2S Clamp (M8/10)
 BIS Heavy Duty Clamp HD500 (BUP1000)

Complementary

BIS Heavy Duty Clamp HD500 (BUP1000)